

## The Urban A06

☑ Nr. camere: 2

☑ Nr. bai: 1

☑ Etaj: 3 / 4

☑ Suprafata construita locuinta = 75.3 m<sup>2</sup>

☑ Suprafata construita totala = 95.6 m<sup>2</sup>

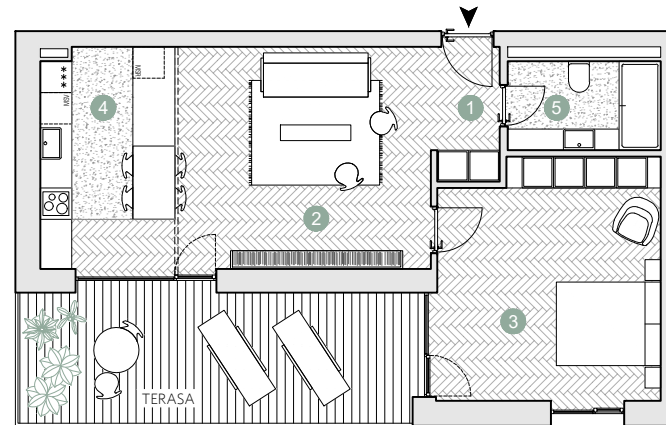

### ETAJ 3

Suprafete utile:

1. hol	3.0 m <sup>2</sup>
2. living & dining	20.9 m <sup>2</sup>
3. dormitor	19.4 m <sup>2</sup>
4. bucatarie	10.9 m <sup>2</sup>
5. baie	4.9 m <sup>2</sup>

.....  
Total suprafete utile etaj 3 59.1 m<sup>2</sup>

**Terasa 20.3 m<sup>2</sup>**

 Prime Kapital

 adn  
BIROU ARCHITECTURA

