

## The Urban SA

✓ Nr. camere: 1 / dormitor separat

✓ Nr. bai: 1

✓ Etaj: 1-3 / 4

✓ Cladire: A1c

✓ Suprafata construita locuinta = 50.6 m<sup>2</sup>

✓ Suprafata construita totala = 57.7 m<sup>2</sup>

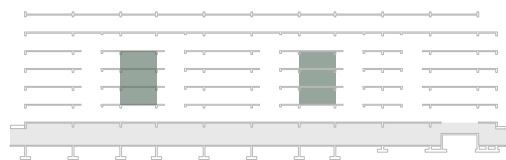

 **Prime Kapital**

 **adn**  
BIROU ARHITECTURA

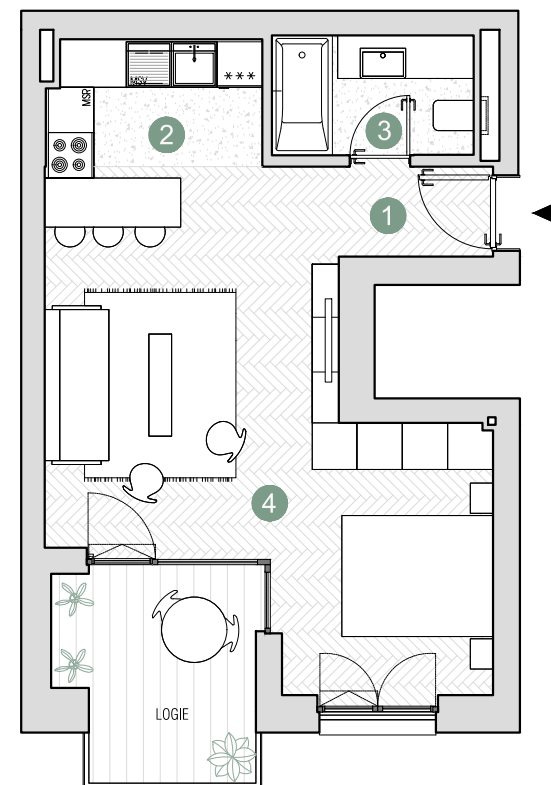
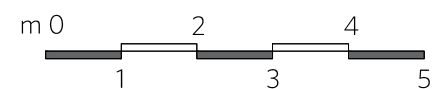

Suprafete utile:

1. hol intrare	3.7 m <sup>2</sup>
2. bucatarie	8.5 m <sup>2</sup>
3. baie	4.5 m <sup>2</sup>
4. living & dormitor	24.2 m <sup>2</sup>

.....  
Total suprafata utila 40.9 m<sup>2</sup>

Logie 7.3 m<sup>2</sup>