

## The Urban SA

☑ Nr. camere: 1 / dormitor separat

☑ Nr. bai: 1

☑ Etaj: 1-3 / 4

☑ Cladire: A1b, A1c

☑ Suprafata construita locuinta = 50.06 m<sup>2</sup>

☑ Suprafata totala = 57.62 m<sup>2</sup>

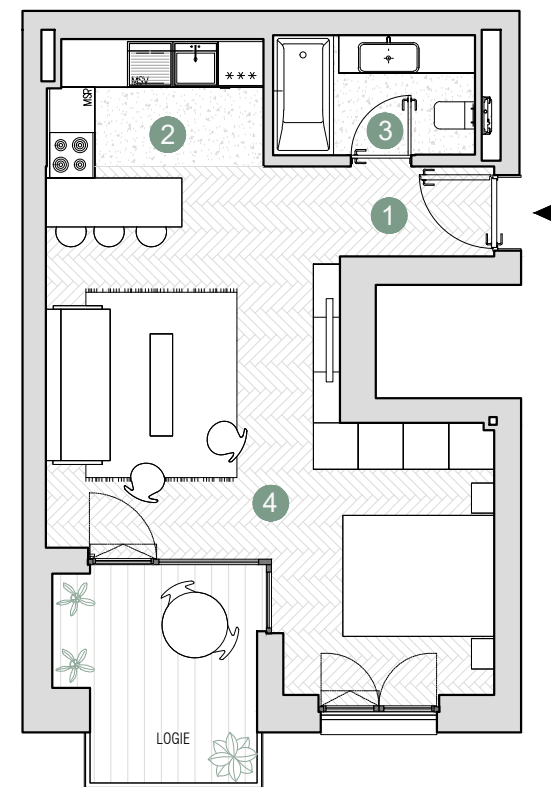
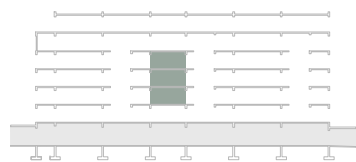

Suprafete utile:

1. hol intrare	2.41 m <sup>2</sup>
2. bucatarie	4.77 m <sup>2</sup>
3. baie	4.3 m <sup>2</sup>
4. living & dormitor	29.22 m <sup>2</sup>

Total suprafata utila 40.71 m<sup>2</sup>

Logie 7.33 m<sup>2</sup>